



THE PLAYERFIRST EXPERIENCE:

FAMILY HOW TOS

PLAYERFIRST V2.0



TABLE OF CONTENTS

Page 3:	Signing Into Your Account
Page 4:	Signing In: Username & Password Help
Page 5:	Your Dashboard
Page 6:	Athlete's Schedule
Page 7:	Athlete's Schedule: Single Event View
Page 8:	Messaging
Page 9:	Messaging: Creating a New Message
Page 10:	Messaging: Group Messages
Page 11:	Team Page
Page 12:	@Home Challenges
Page 13:	@Home Challenges: How to Complete
Page 14:	@Home Challenges: Completed View
Page 15:	Accessing Profiles
Page 16:	Notification Settings
Page 17:	Sharing Your Login Info



SIGNING INTO YOUR ACCOUNT

Note: If logging in to complete an @Home Challenge, the player must choose themselves when logging in (not the parent).

4:09 46°

SIGN IN



USERNAME

PASSWORD

SIGN IN

Your PlayerFirst sign in is the same as on your club's website

[SIGN IN WITH AN ACCESS CODE](#)

[RETRIEVE SIGN IN INFO](#)

Use the same Username & Password as on your club's website.

You will no longer get logged out with any app updates within this 2.0 version.

4:16 46°

SIGN IN



[I AM A PARENT](#) >

[I AM AN ATHLETE](#) >

PARENTS CAN VIEW ALL THEIR ATHLETE SCHEDULES

If you're a parent, select "I AM A PARENT." You will be able to view all athlete schedules.

Only athletes should select "I AM AN ATHLETE." Afterwards, you will be guided through additional steps to access your correct account.



SIGNING IN: USERNAME & PASSWORD HELP

GO TO THE PLAYERFIRST PAGE ON YOUR CLUB'S WEBSITE AND FOLLOW THE STEPS TO RETRIEVE YOUR LOGIN INFO.

PLAYERFIRST
LOG IN

Use Your Club's PlayerFirst Login ⓘ

Username

Password

LOG IN

Need Help? [Retrieve Your Login](#)
[Create an Account](#)

CLICK "RETRIEVE YOUR LOGIN"
YOU DON'T HAVE YOUR
USERNAME OR PASSWORD

RETRIEVE PLAYERFIRST LOGIN

I NEED MY USERNAME

I HAVE MY USERNAME, BUT NEED MY PASSWORD

[Back to Log In](#)

If you are still having trouble after following the above reset link instructions, email
support@playerfirsttech.com



YOUR DASHBOARD

MAIN PAGE THAT HIGHLIGHTS YOUR MOST CURRENT AND IMPORTANT CONTENT:
RECENT MESSAGES, UPCOMING EVENTS, ALERTS AND MORE!

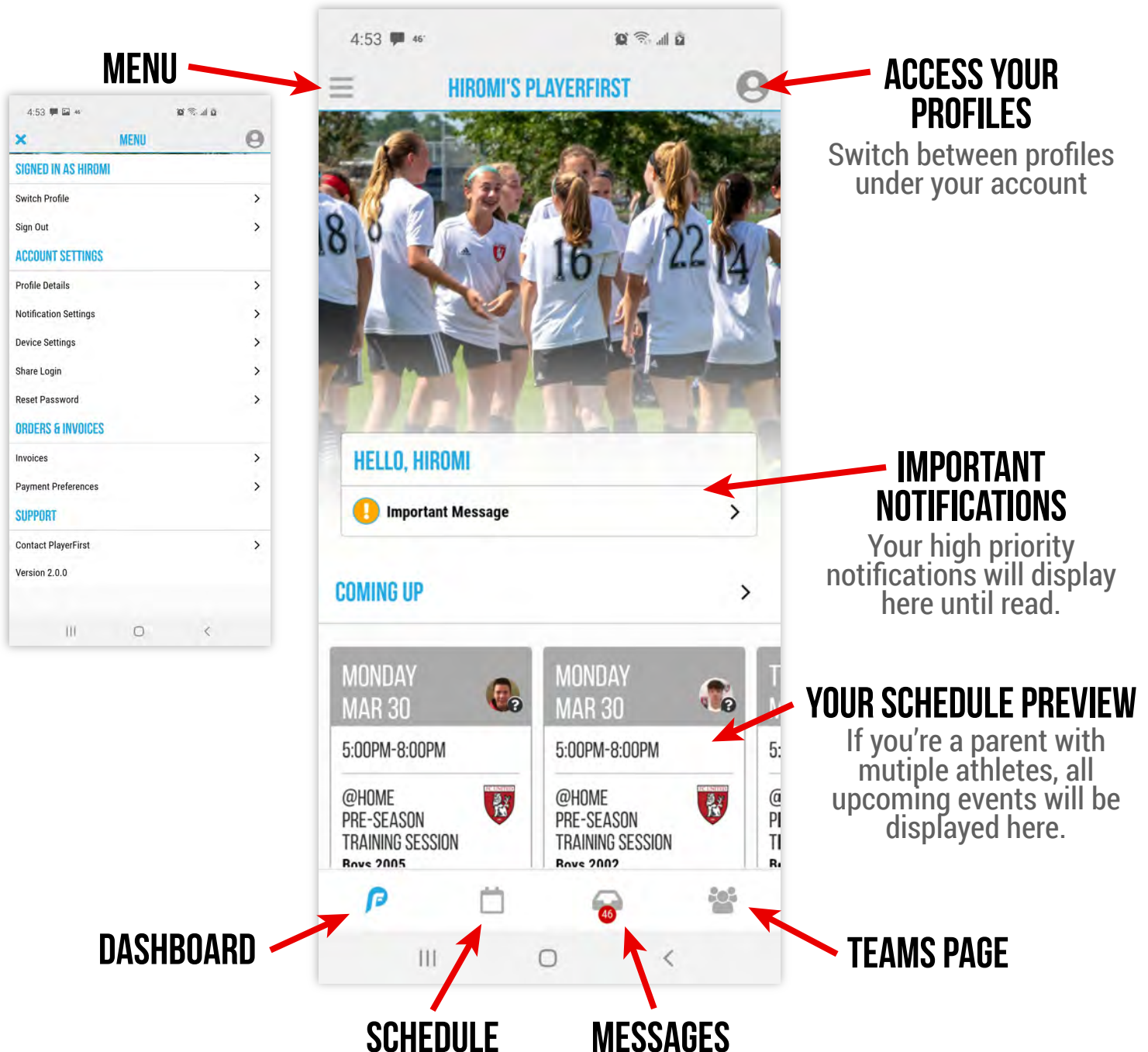



ATHLETE'S SCHEDULE

VIEW SCHEDULE & UPDATE PLAYER ATTENDANCE (BY EVENT)

CALENDAR VIEW
TOGGLE

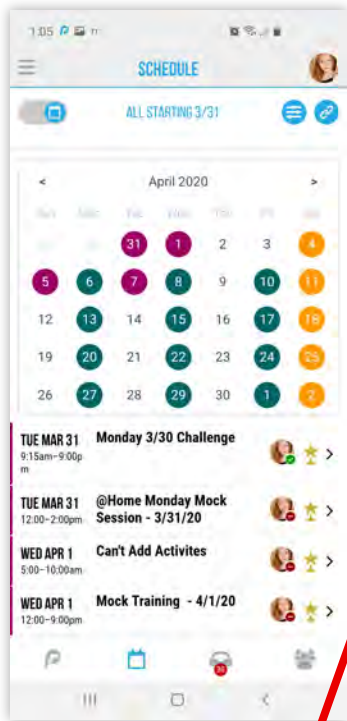

NEW FILTER BY ATHLETE
Only when logged in as a parent. Click to turn on/off each athlete's schedule from the list view. Default shows all calendars.

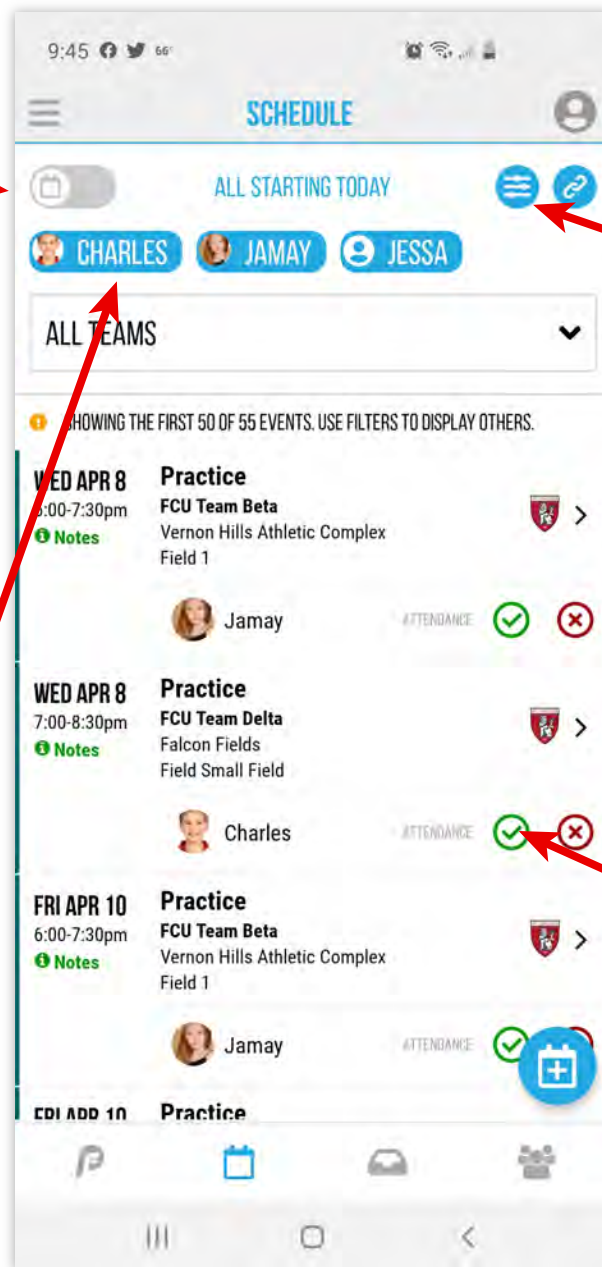

EXPORT CALENDAR

NEW SCHEDULE FILTERS

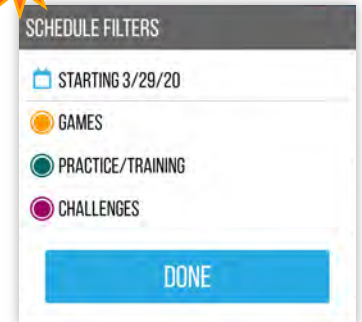

Click on "Starting Today"
to view past events

Choose event types to
display only certain ones.

ATTENDANCE

CLICK ON INDIVIDUAL DATES/EVENTS TO VIEW MORE DETAILS



ATHLETE'S SCHEDULE: SINGLE EVENT VIEW

GET LOCATION DETAILS

FOR GAMES, VIEW TEAMS & SCORE

UPDATE PLAYER ATTENDANCE

VIEW TEAM ATTENDANCE

GET SPECIFIC EVENT DETAILS
Which uniform to wear, arrival time, additional notes

CLICK SHORTCUT MENU TO MESSAGE TEAM



MESSAGING

MANAGE INBOX, MESSAGE YOUR COACH/MANAGER/TEAMMATES/PARENTS

NEW CLICK BOX
TO ARCHIVE OR MARK
AS READ

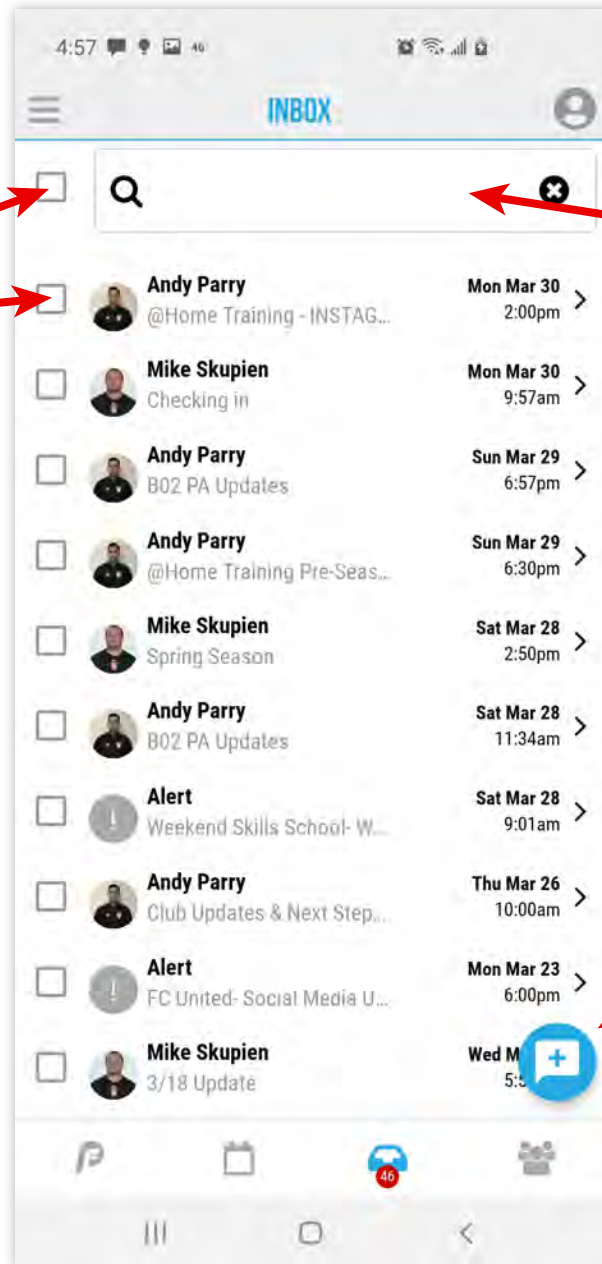
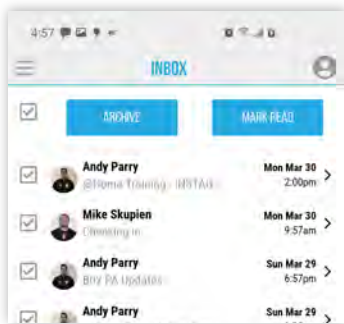

NEW SEARCH
THROUGH MESSAGES

**CLICK TO CREATE
NEW MESSAGE**
View more details on
next page



MESSAGING: CREATING A NEW MESSAGE

MESSAGE YOUR COACH/MANAGER/TEAMMATES/PARENTS

To view entire team list,
click the "Individuals" check-
mark button

ADD ATTACHMENTS

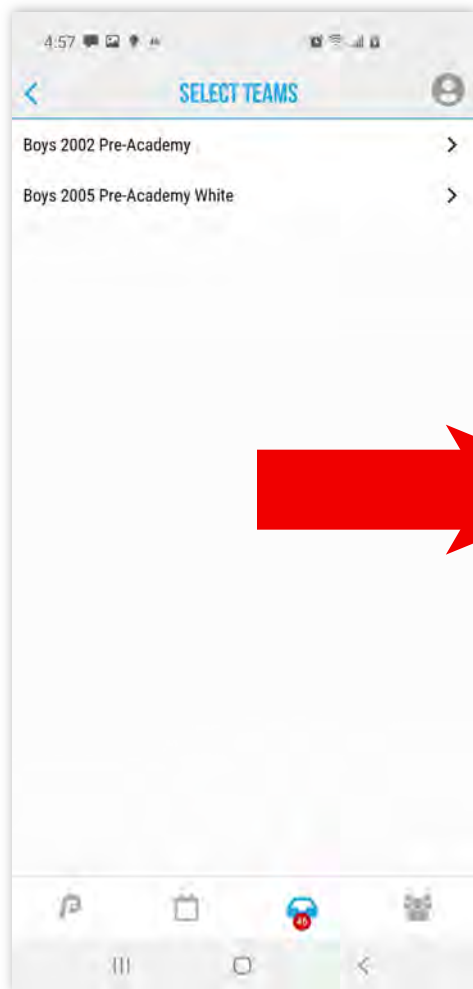

SELECT YOUR TEAM

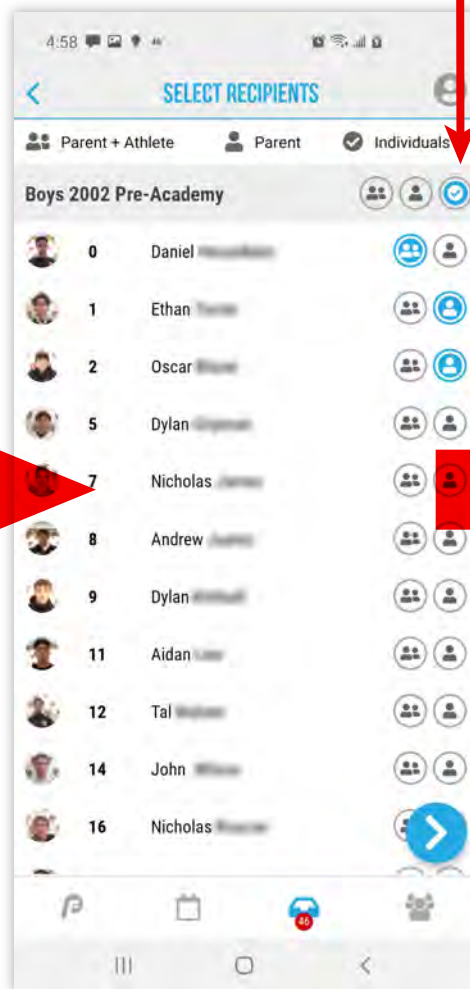

SELECT YOUR RECIPIENTS

Select to message whole team
or just specific individuals.
Must select "Parent" or "Parent
+ Athlete." You don't have the
capability to solely message
athletes.

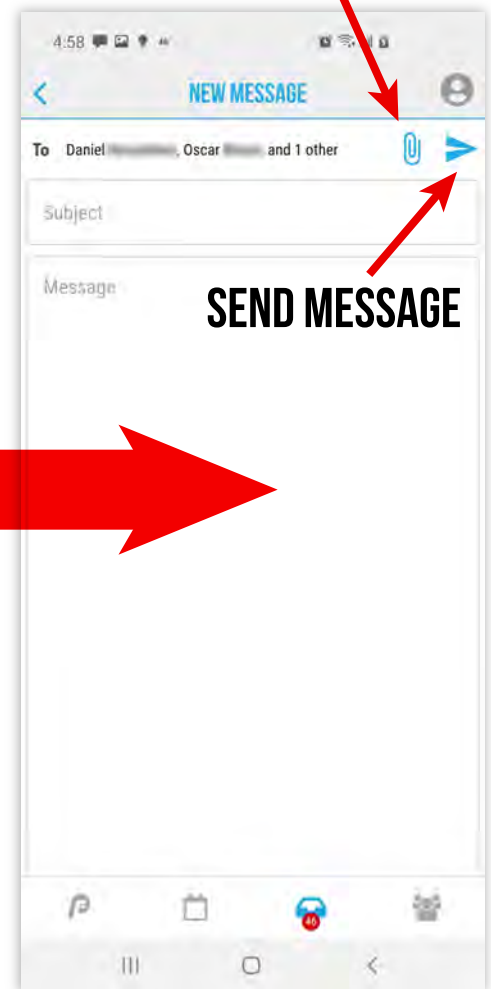

NEW MESSAGE



MESSAGING: GROUP MESSAGES

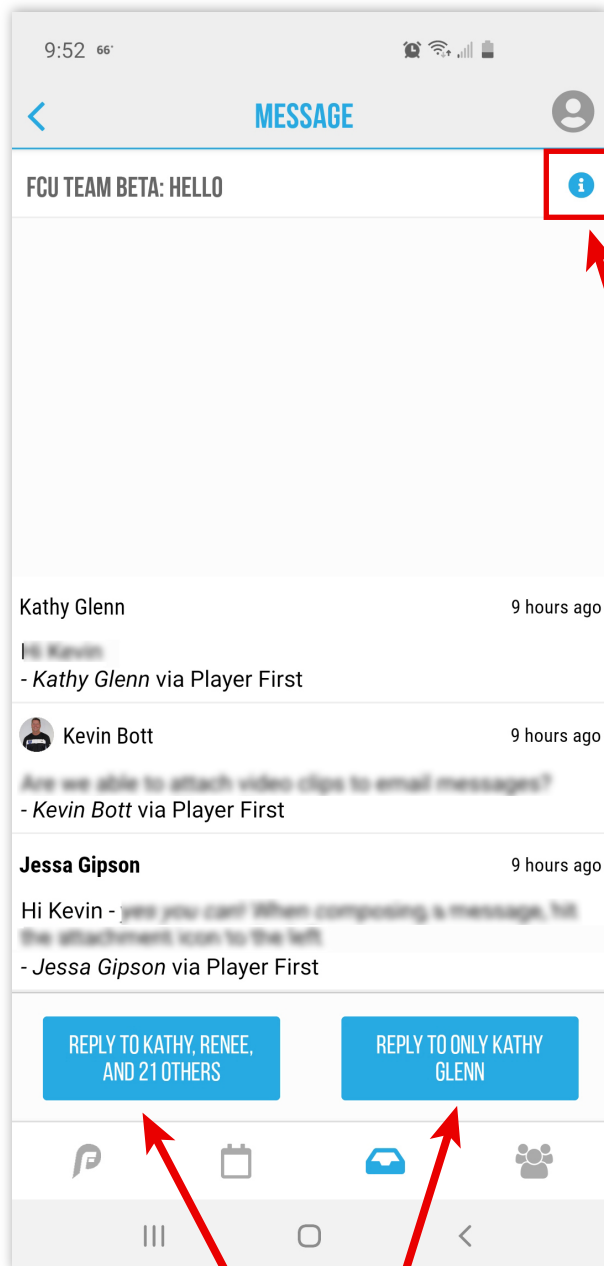

GROUP MESSAGE VIEW

Reply to the whole group or just to who started the message

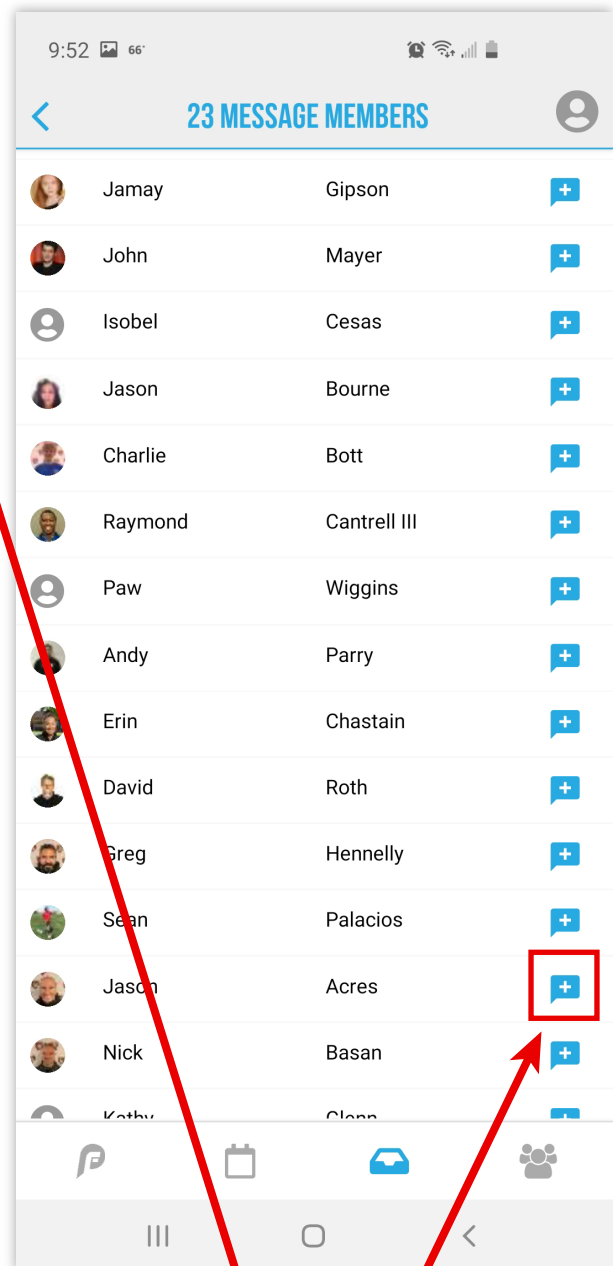

NEW MESSAGE INDIVIDUALS FROM GROUP

Click top right "i" icon to view everyone in the group. Click message icon on the right to start a new message.



TEAM PAGE

KEEP TRACK OF ALL YOUR TEAMS, SCHEDULED EVENTS, STANDINGS & MORE!

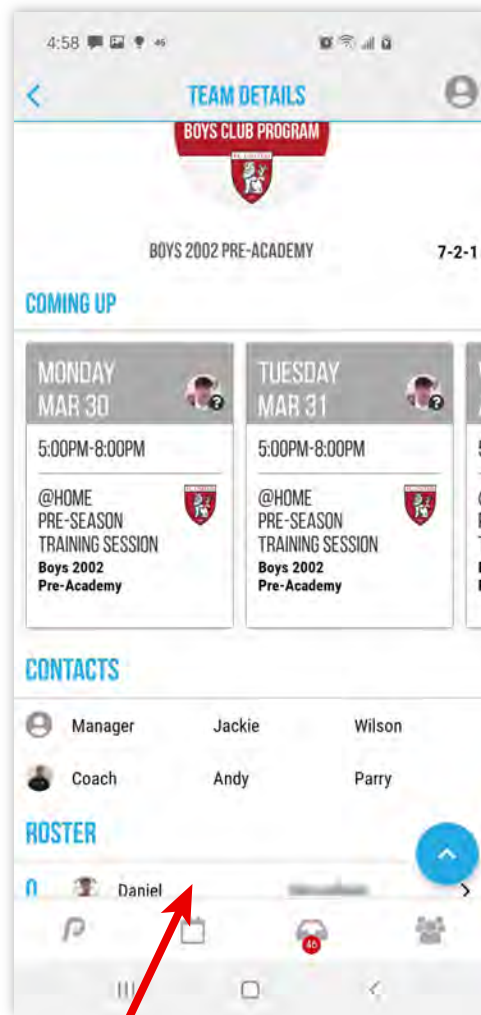
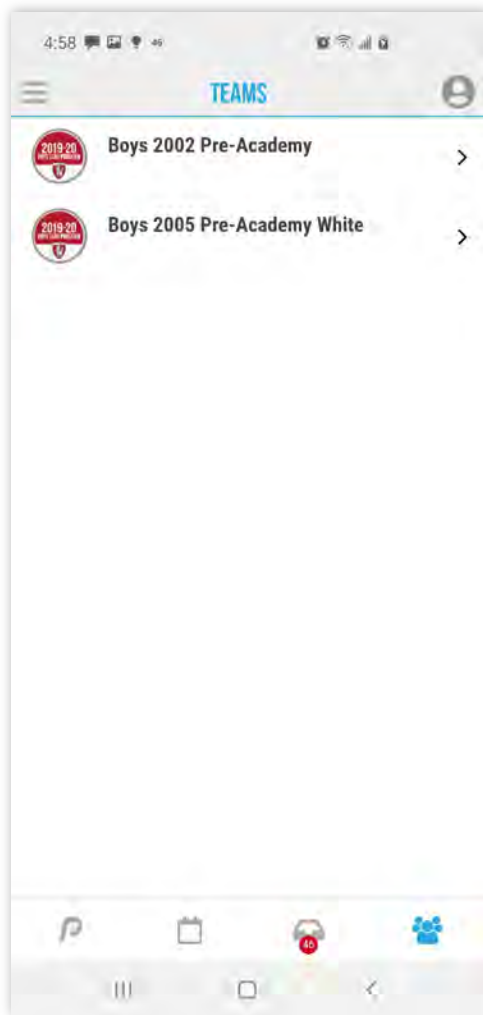

CLICK PLAYER'S NAME IN THE ROSTER TO VIEW ATHLETE PROFILE & PARENT CONTACT INFO

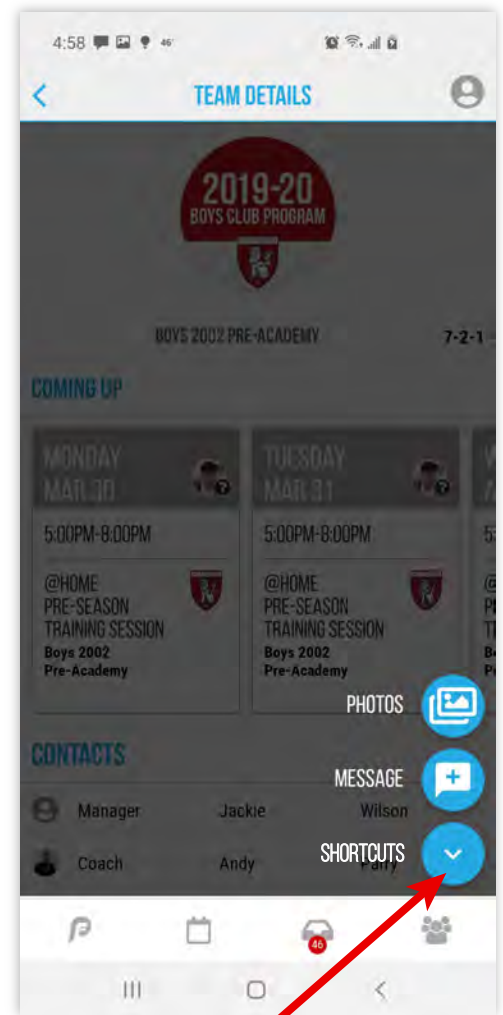

NEW **CLICK SHORTCUT MENU TO ACCESS ADDITIONAL OPTIONS: MESSAGE TEAM & TEAM PHOTO GALLERY**

View, download and upload your team photos!



@HOME CHALLENGES

GET CHALLENGED BY A SERIES OF ACTIVITIES, COMPILED BY YOUR COACH.
COMPLETE THE CHALLENGE, INPUT YOUR DATA AND PHOTOS/VIDEOS, SEE YOUR
RANKING IN THE LEADERBOARD!

TOTAL AVAILABLE
ACTIVITIES
IN THE CHALLENGE

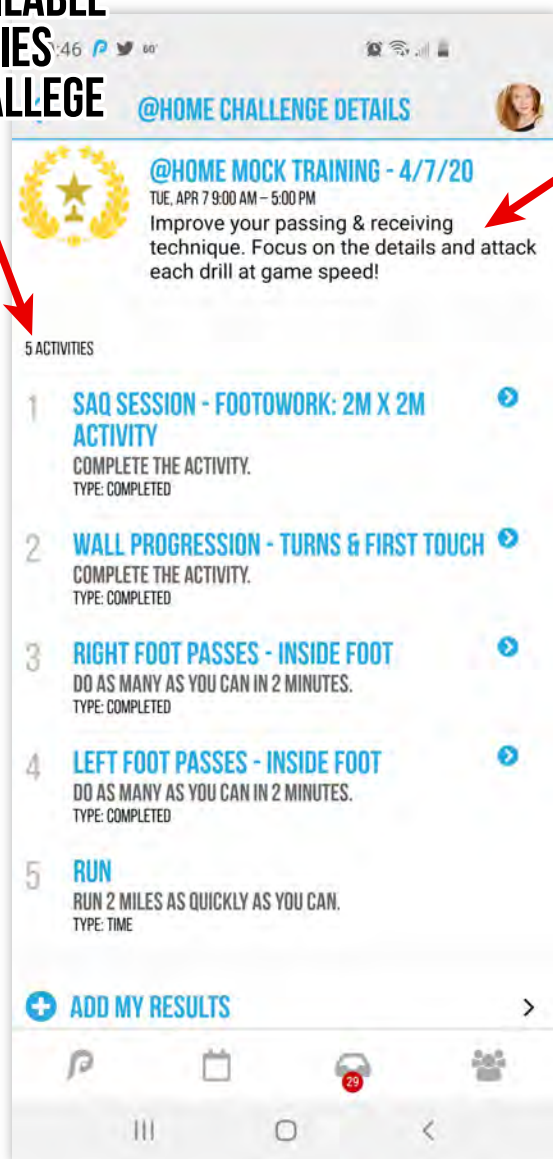

CHALLENGE NOTES

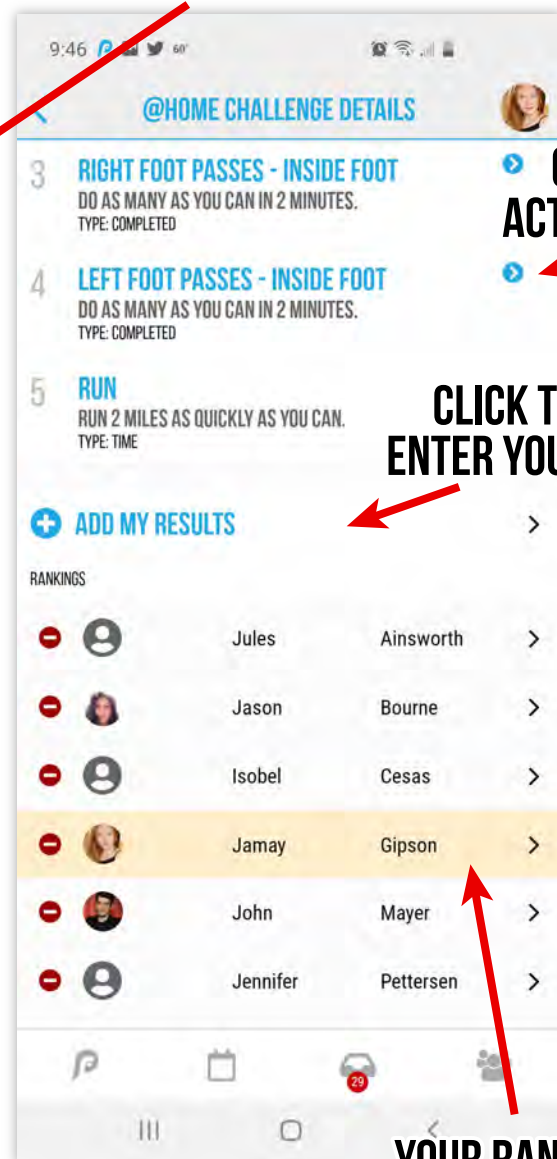

CLICK FOR
ACTIVITY NOTES

CLICK TO VIEW &
ENTER YOUR CONTENT

YOUR RANKING

Team rankings only show if
leaderboard feature is on*

*Leaderboards will only show if coach chooses to turn on that feature.
For more detailed instructions, please view our additional challenges tutorial.



@HOME CHALLENGES: HOW TO COMPLETE

CHALLENGES CAN ONLY BE COMPLETED DURING THE SCHEDULED TIMEFRAME.
PARENTS CANNOT ENTER ACTIVITY SCORES/COMPLETIONS, ONLY ATHLETES.

ENTER EVIDENCE
(PHOTOS/VIDEO/LINKS)
Always optional

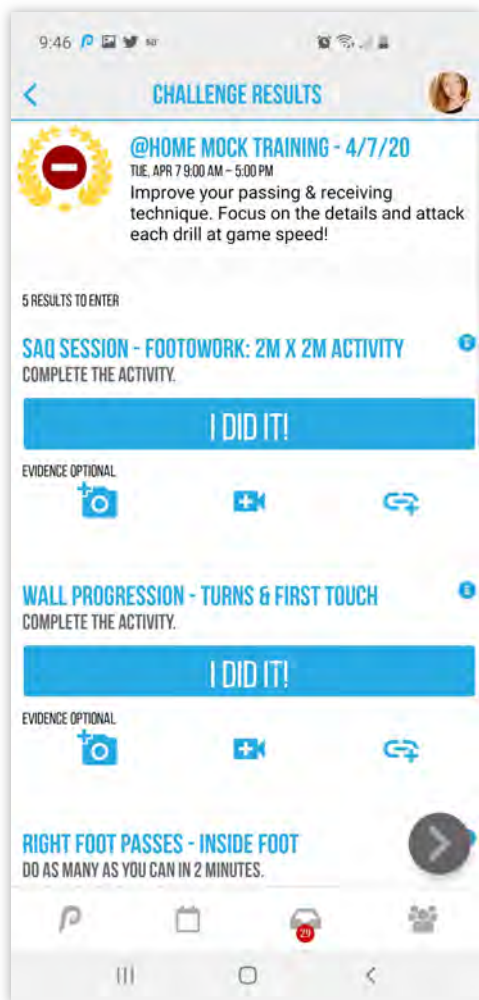

UNFINISHED ACTIVITIES

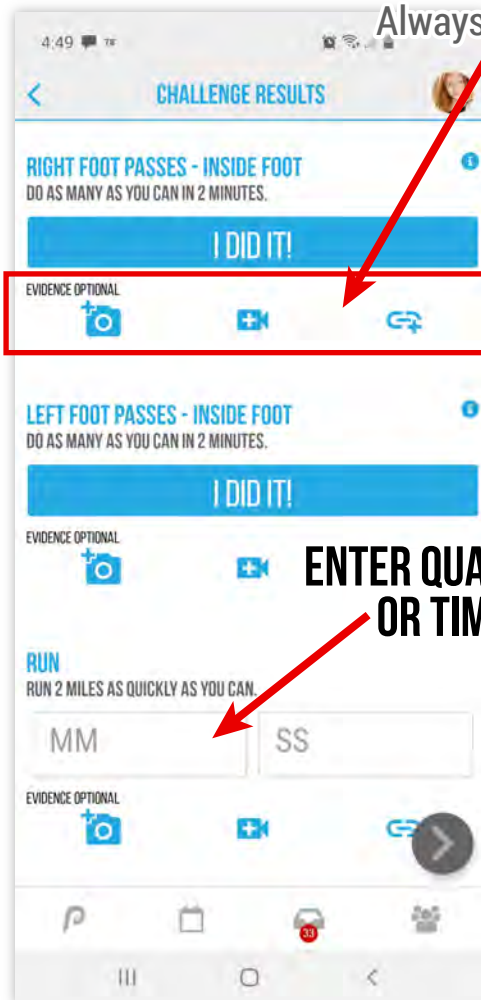

ENTER YOUR RESULTS

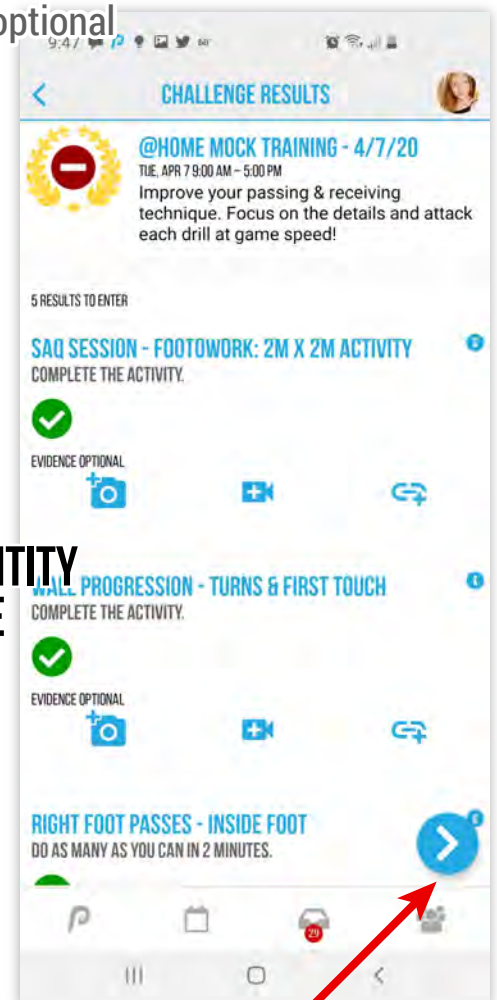

SUBMIT RESULTS

For more detailed instructions, please view our additional challenges tutorial.



@HOME CHALLENGES: COMPLETED VIEW

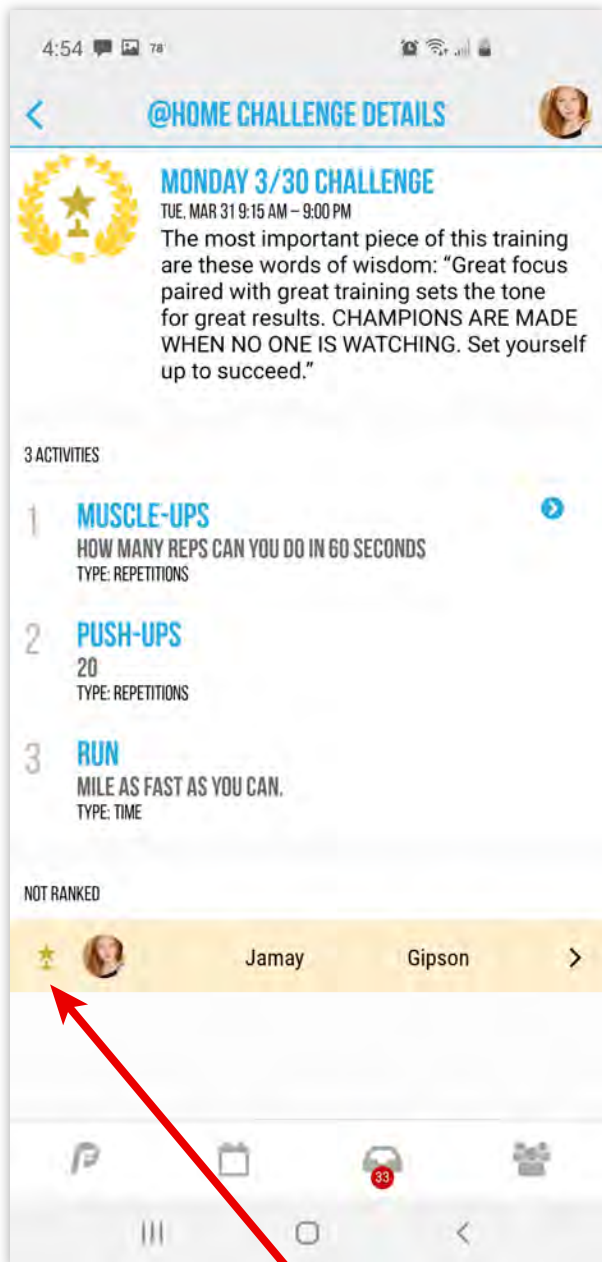

**COMPLETED CHALLENGES
DISPLAY AS CHECKMARKS OR
PLACEMENT TROPHIES**

Team rankings only show if
leaderboard feature is on. Completing
Challenges is optional.

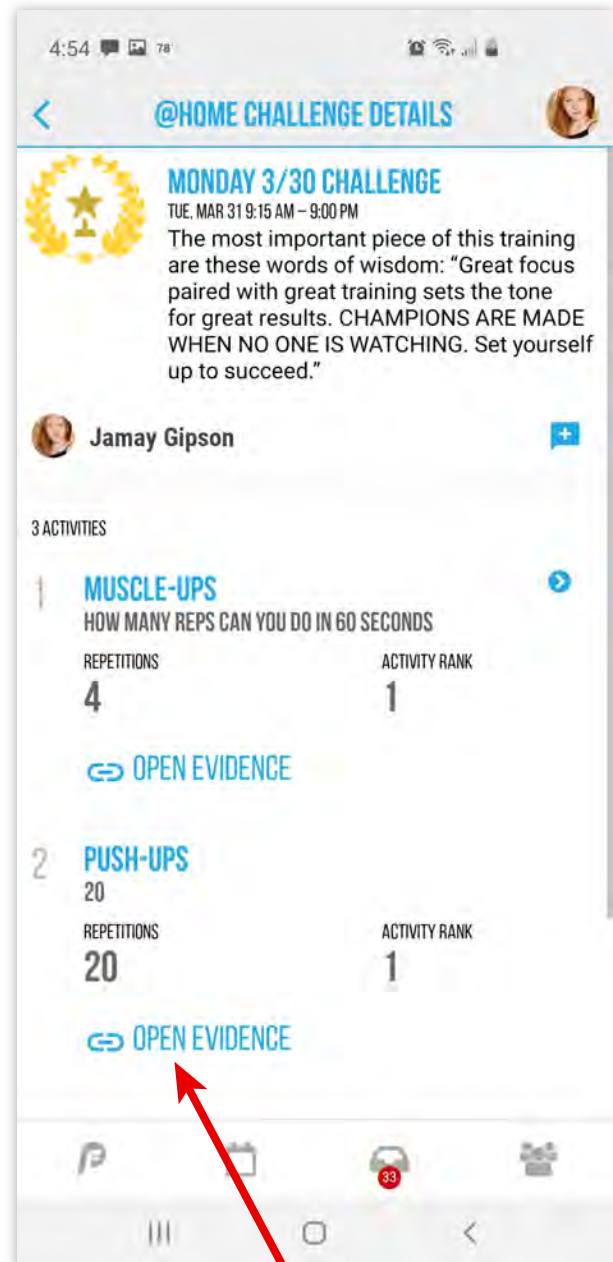

**CLICK TO VIEW
ACTIVITY EVIDENCE**



ACCESSING PROFILES

HOW TO VIEW, EDIT AND SWITCH BETWEEN USER PROFILES

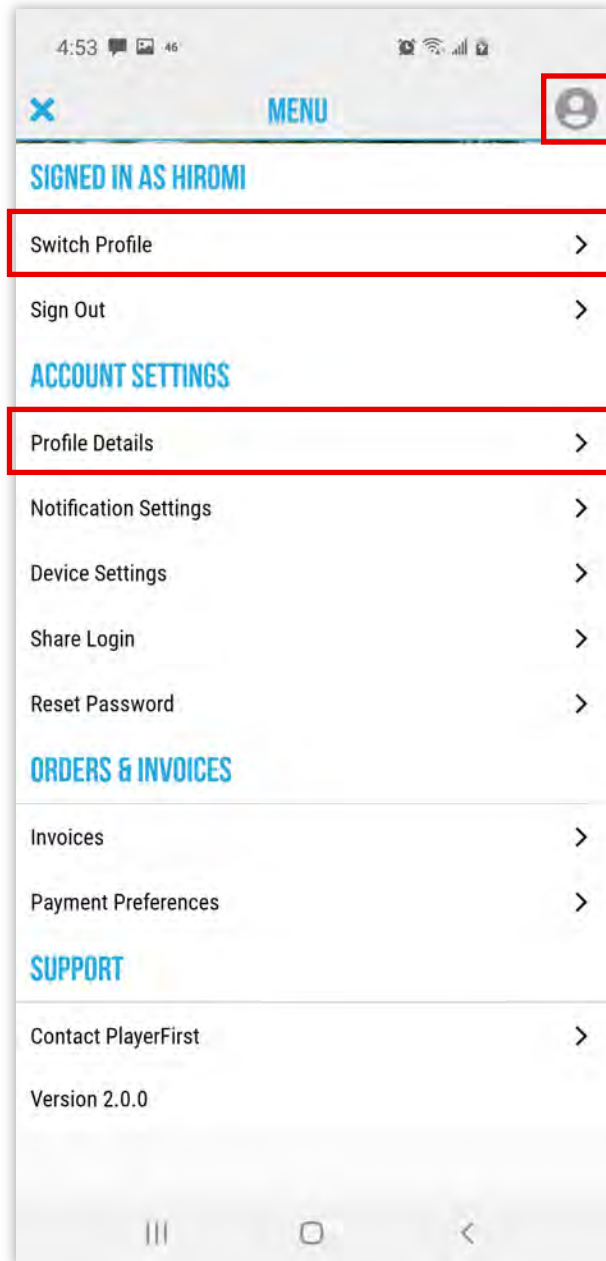



NOTIFICATION SETTINGS

CUSTOMIZE NOTIFICATION SETTINGS BY DEVICE OR BY INDIVIDUAL PROFILES.
CAN BE FOUND IN THE TOP LEFT MENU.

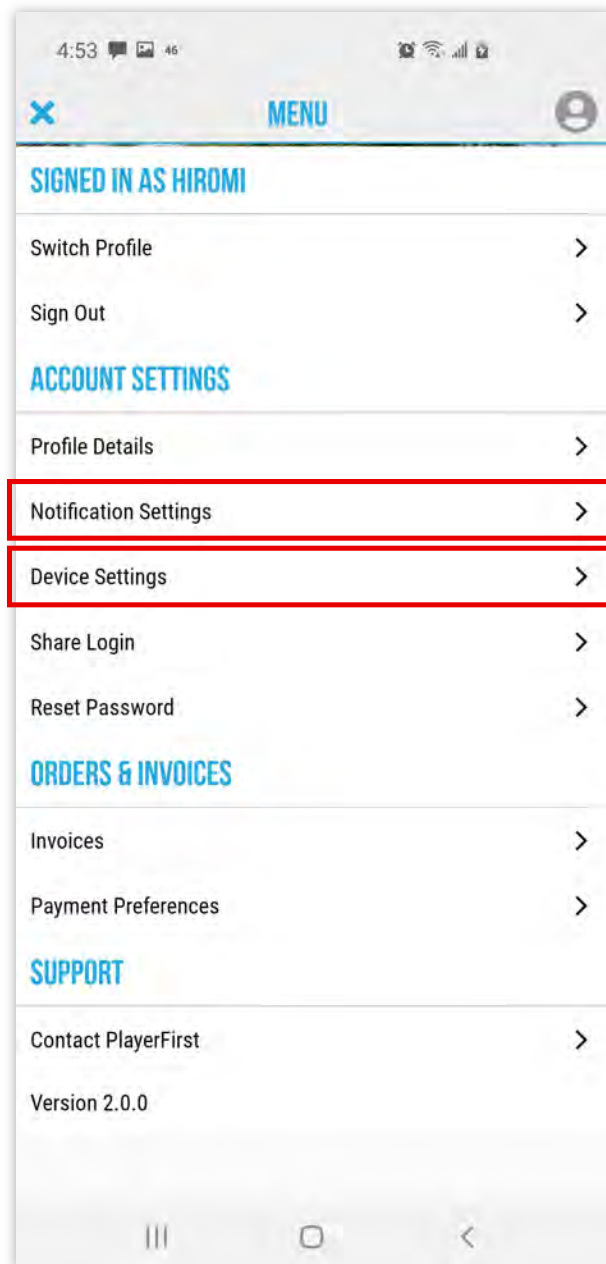

Manage how you receive notifications for schedule changes and messages from coaches, teammates, parents and the club



SHARING YOUR LOGIN INFO

SHARE A LOGIN CODE WITH ATHLETES OR OTHER FAMILY MEMBERS SO THEY HAVE ACCESS TO YOUR PROFILE AND SCHEDULE. CAN BE FOUND IN THE TOP LEFT MENU. ONLY VIEWABLE IN PARENT PROFILE.

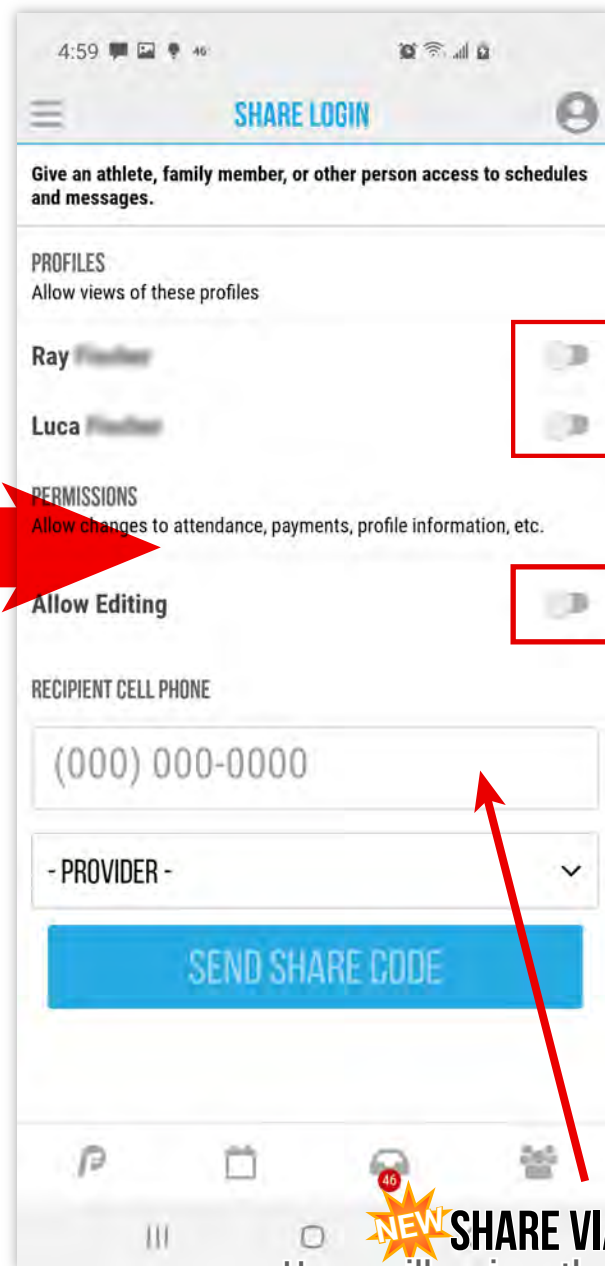
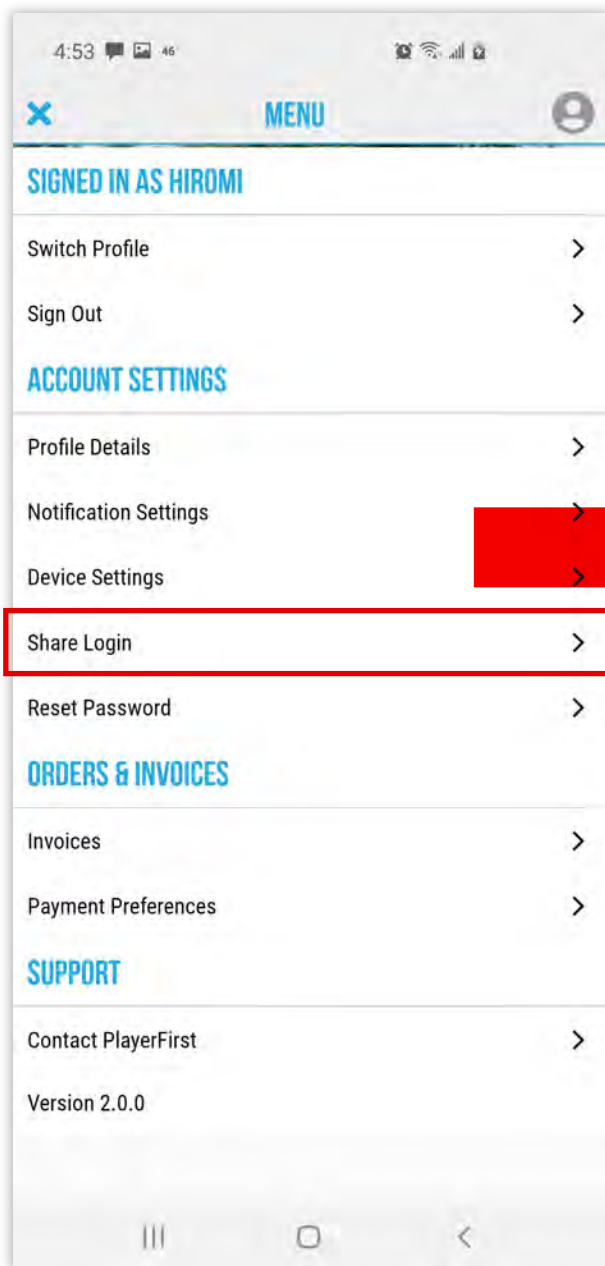

SELECT USER

PERMISSIONS
Flip this toggle to limit user access.

NEW SHARE VIA TEXT

Users will receive the following text:
You are invited to sign in to the PlayerFirst app with username: xxxxxx and access code: xxxxxxxx. Invite expires in 24 hours.